

GROUND LEVEL

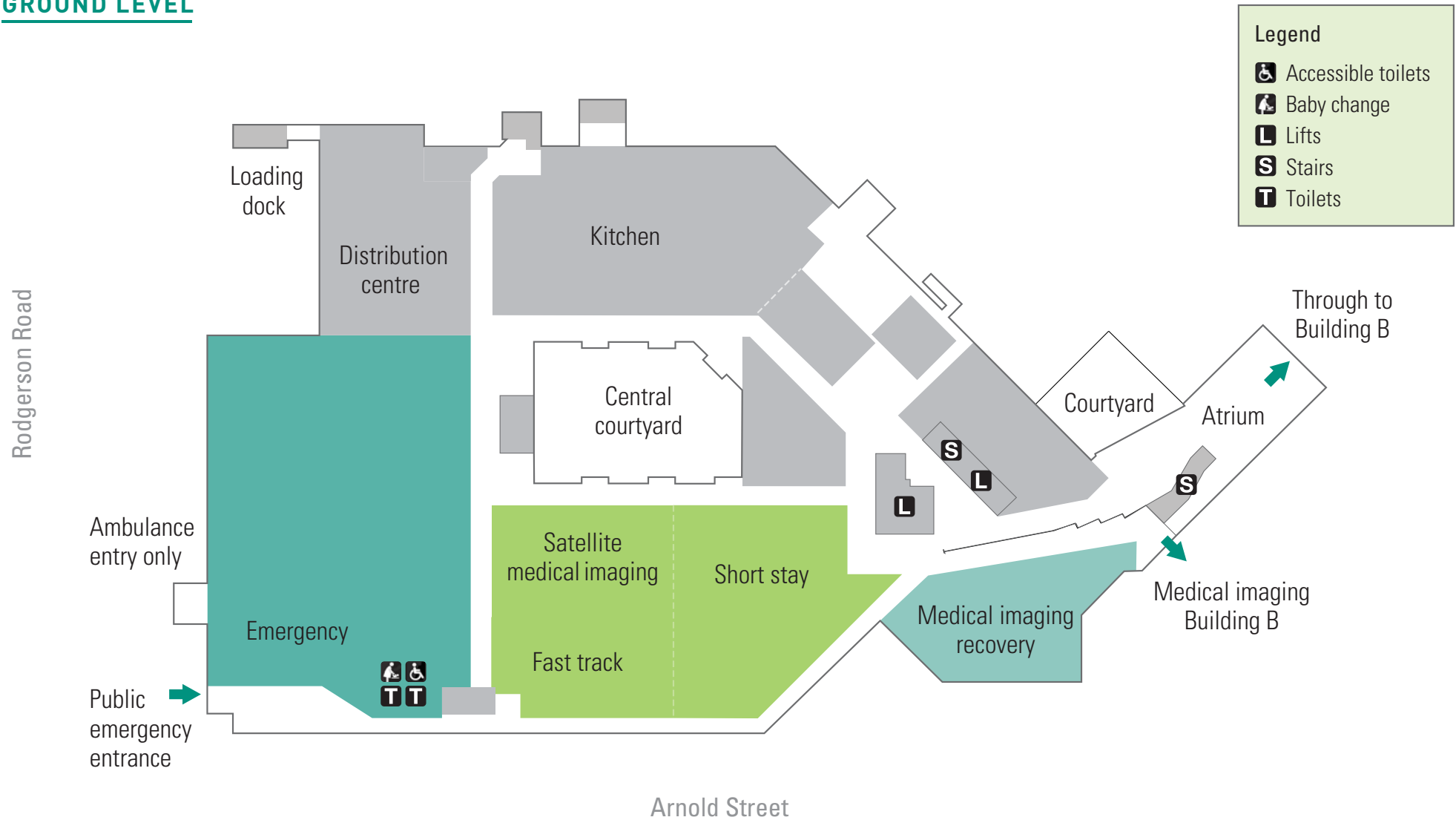

BOX HILL HOSPITAL BUILDING A

8 Arnold Street, Box Hill

EASTERN HEALTH: 1300 342 255

LEVEL 1

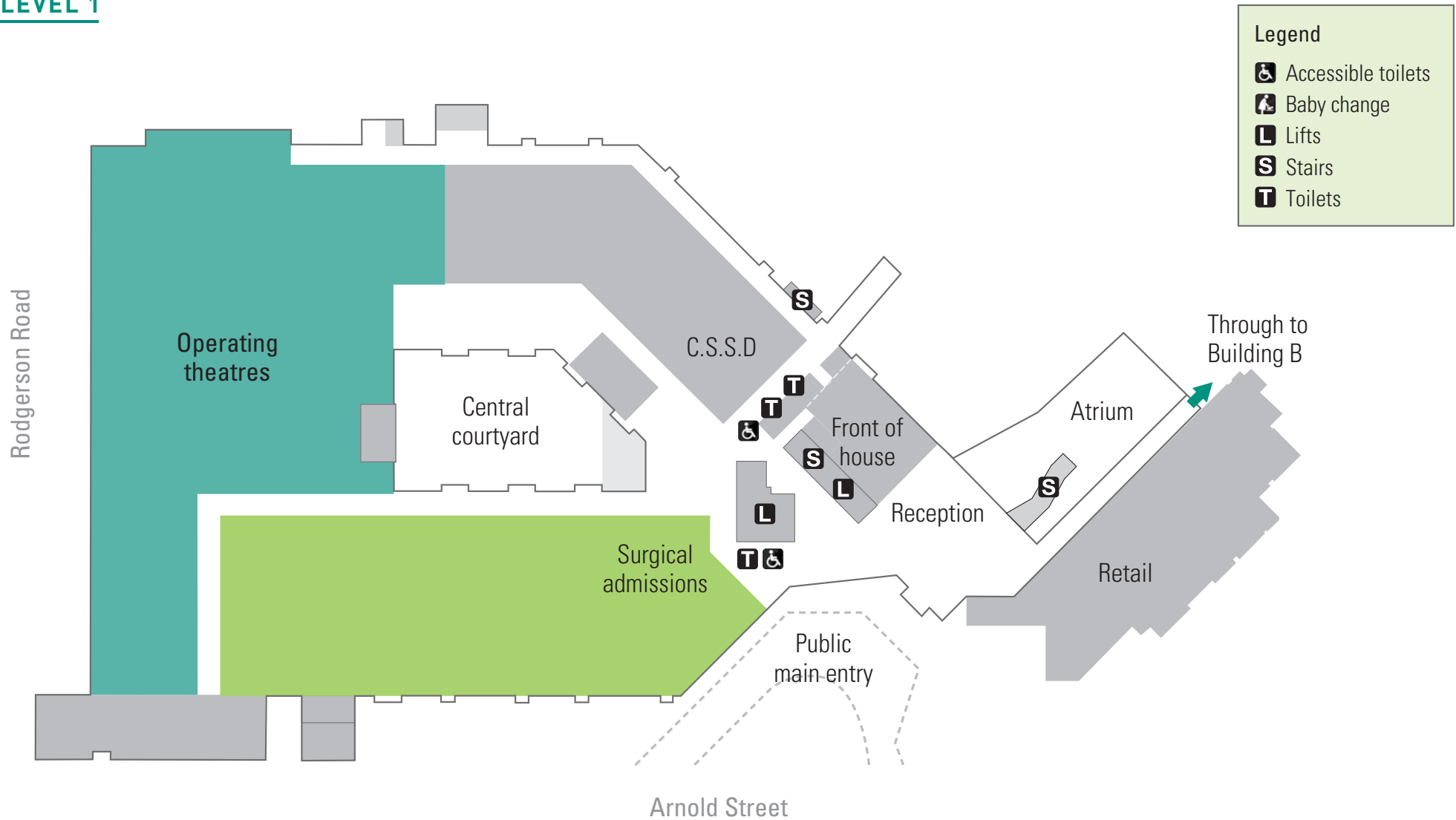

BOX HILL HOSPITAL BUILDING A
8 Arnold Street, Box Hill
EASTERN HEALTH: 1300 342 255

LEVEL 2

2.1

Intensive care
Cardiac catheter
laboratory

Ward 2.2

Cardiology
Respiratory

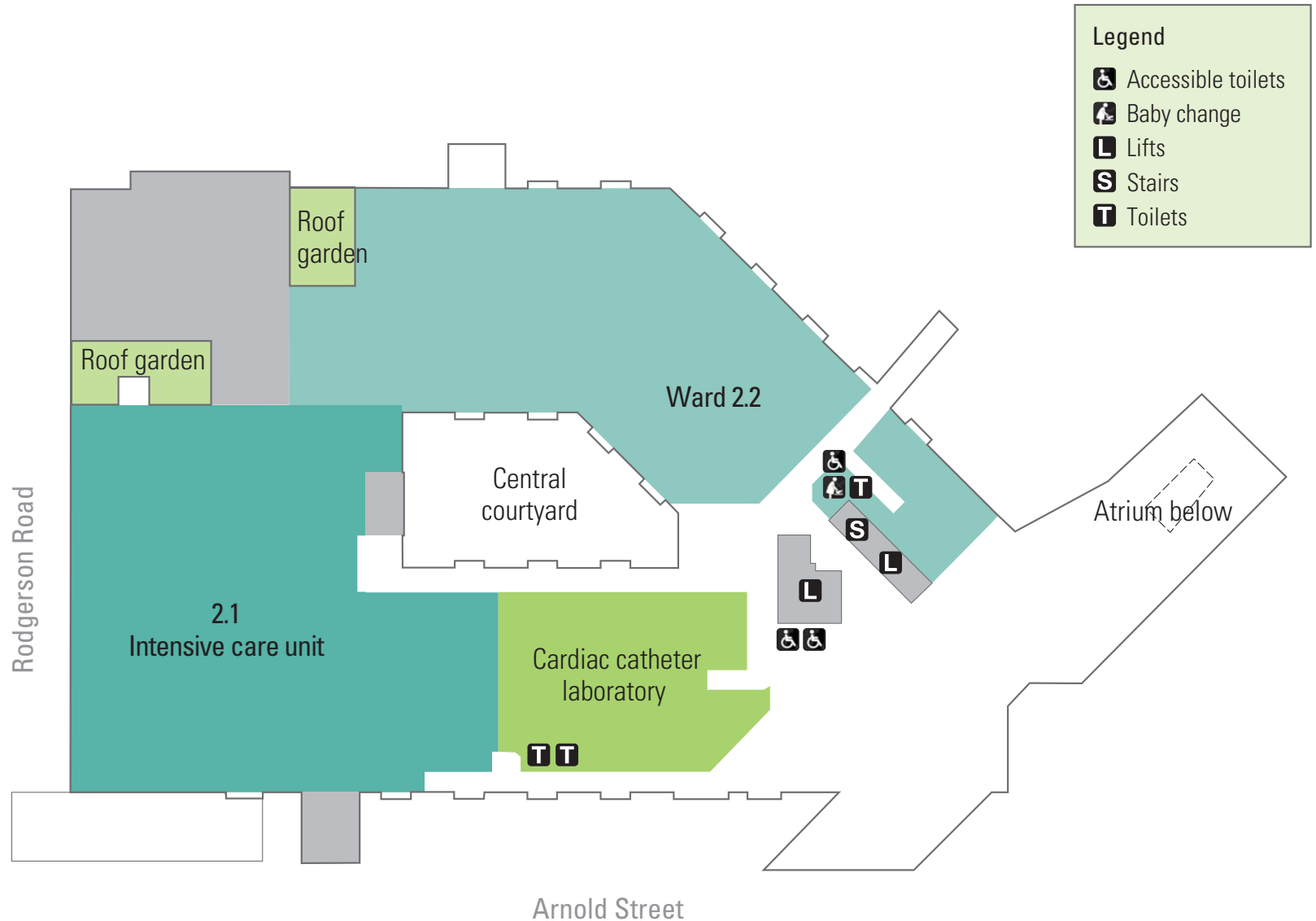

BOX HILL HOSPITAL BUILDING A

8 Arnold Street, Box Hill

EASTERN HEALTH: 1300 342 255

LEVEL 3

Ward 3.1

Maternity

3.2

Specialist clinics

Fetal monitoring and
assessment

Ward 3.3

Special care nursery

3.4

Birthing

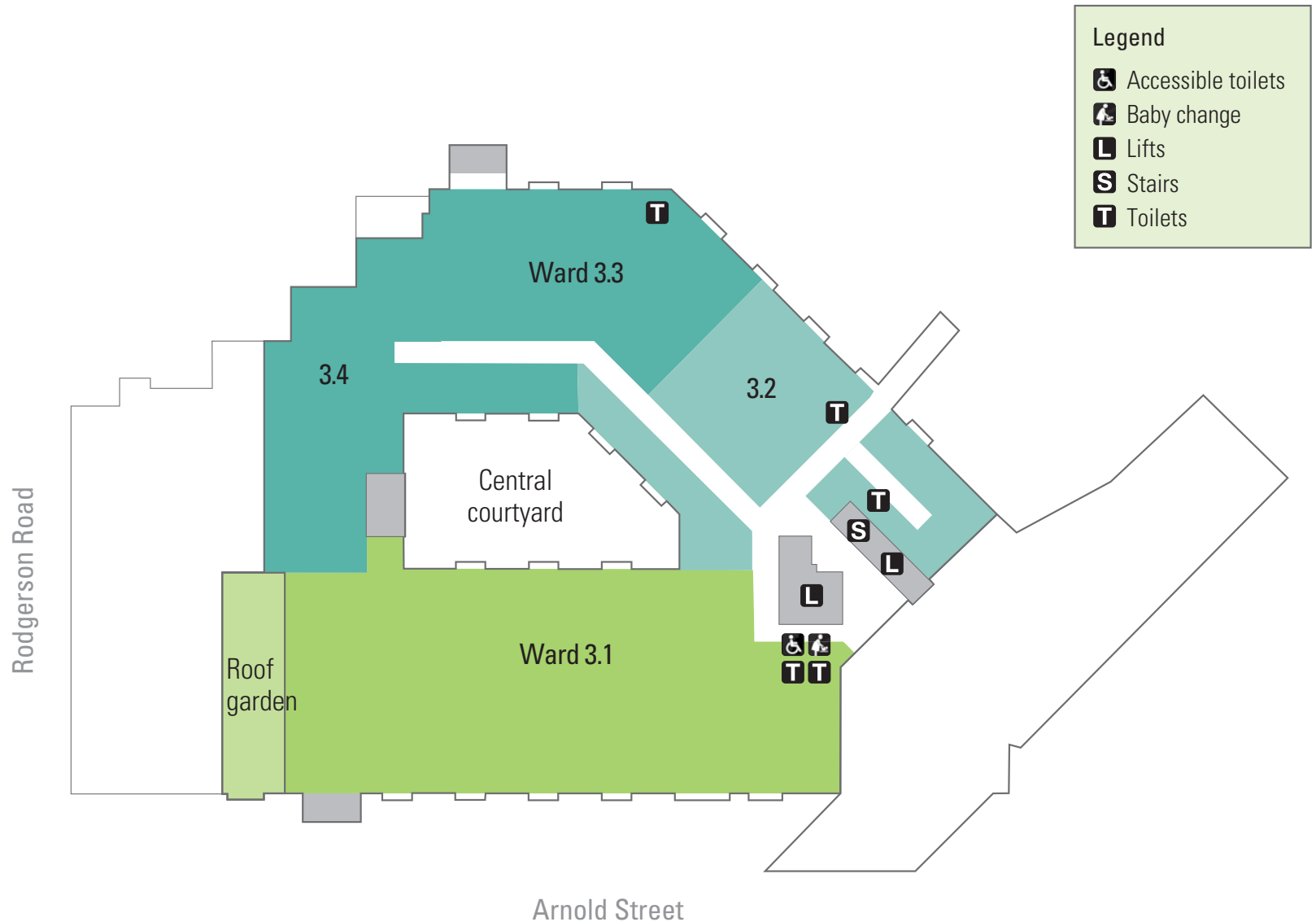

BOX HILL HOSPITAL BUILDING A

8 Arnold Street, Box Hill

EASTERN HEALTH: 1300 342 255

LEVEL 4

Ward 4.1

Cancer services
Haemostasis-Thrombosis
Haematology

4.2

Specialist clinics
Pharmacy

4.3

Day oncology and
medical

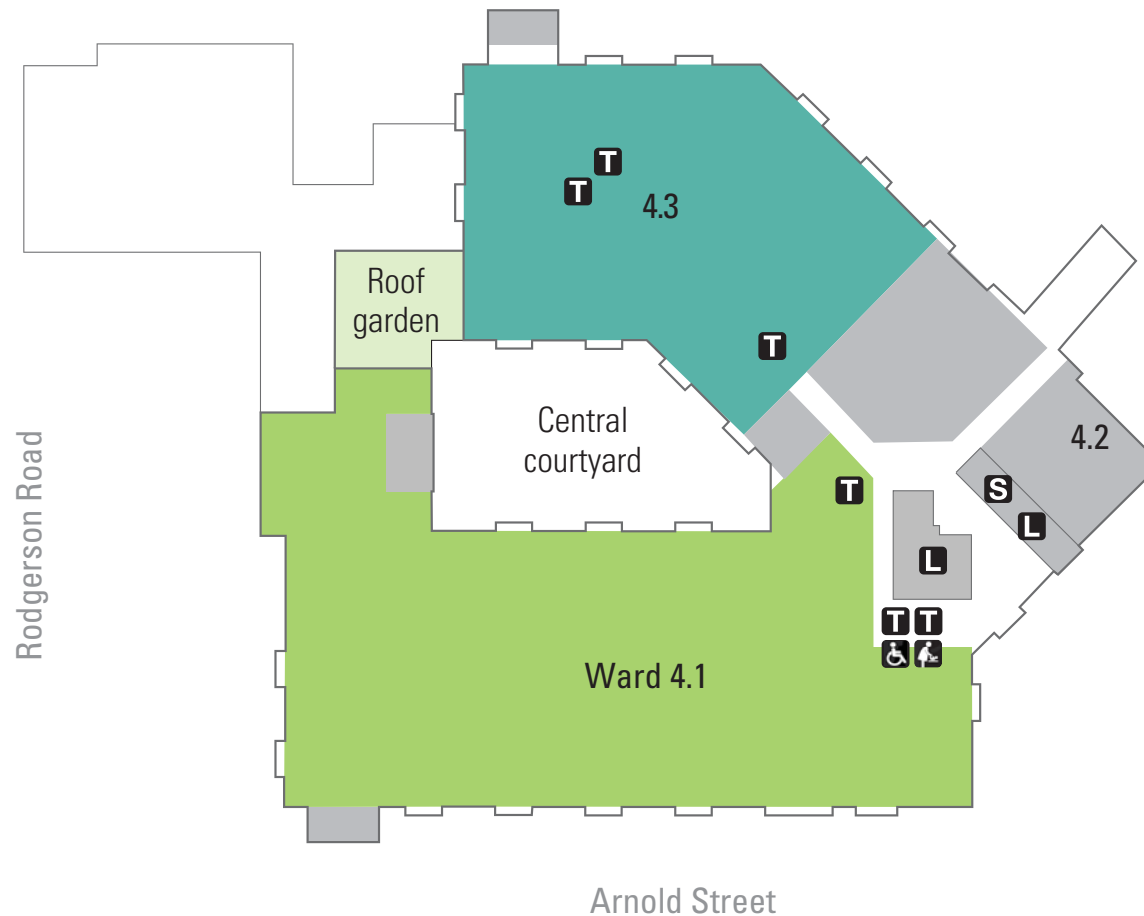

Legend

- Accessible toilets
- Baby change
- Lifts
- Stairs
- Toilets

BOX HILL HOSPITAL BUILDING A

8 Arnold Street, Box Hill

EASTERN HEALTH: 1300 342 255

LEVEL 5

Ward 5.1

Future growth

5.2

Sleep laboratory

Ward 5.3

Paediatrics

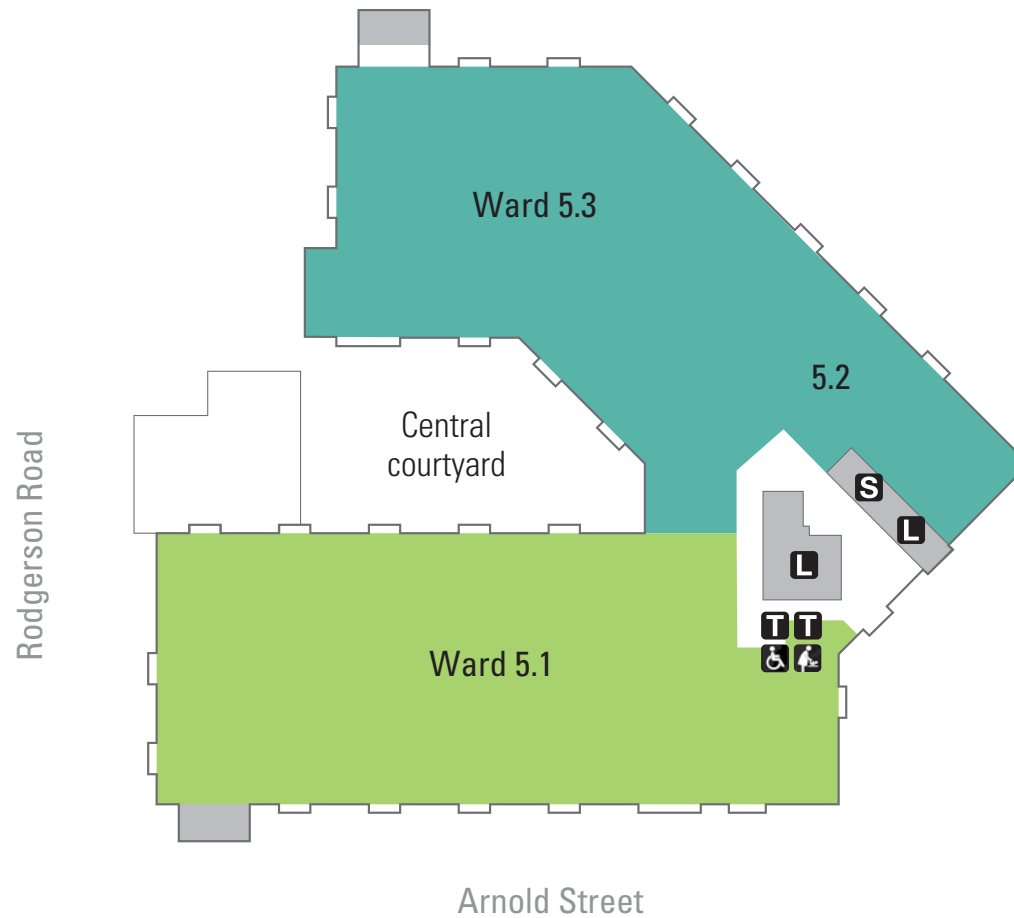

Legend

- Accessible toilets
- Baby change
- Lifts
- Stairs
- Toilets

BOX HILL HOSPITAL BUILDING A

8 Arnold Street, Box Hill

EASTERN HEALTH: 1300 342 255

LEVEL 6

Ward 6.1

Acute Medical Unit 1

Ward 6.2

Acute Medical Unit 2

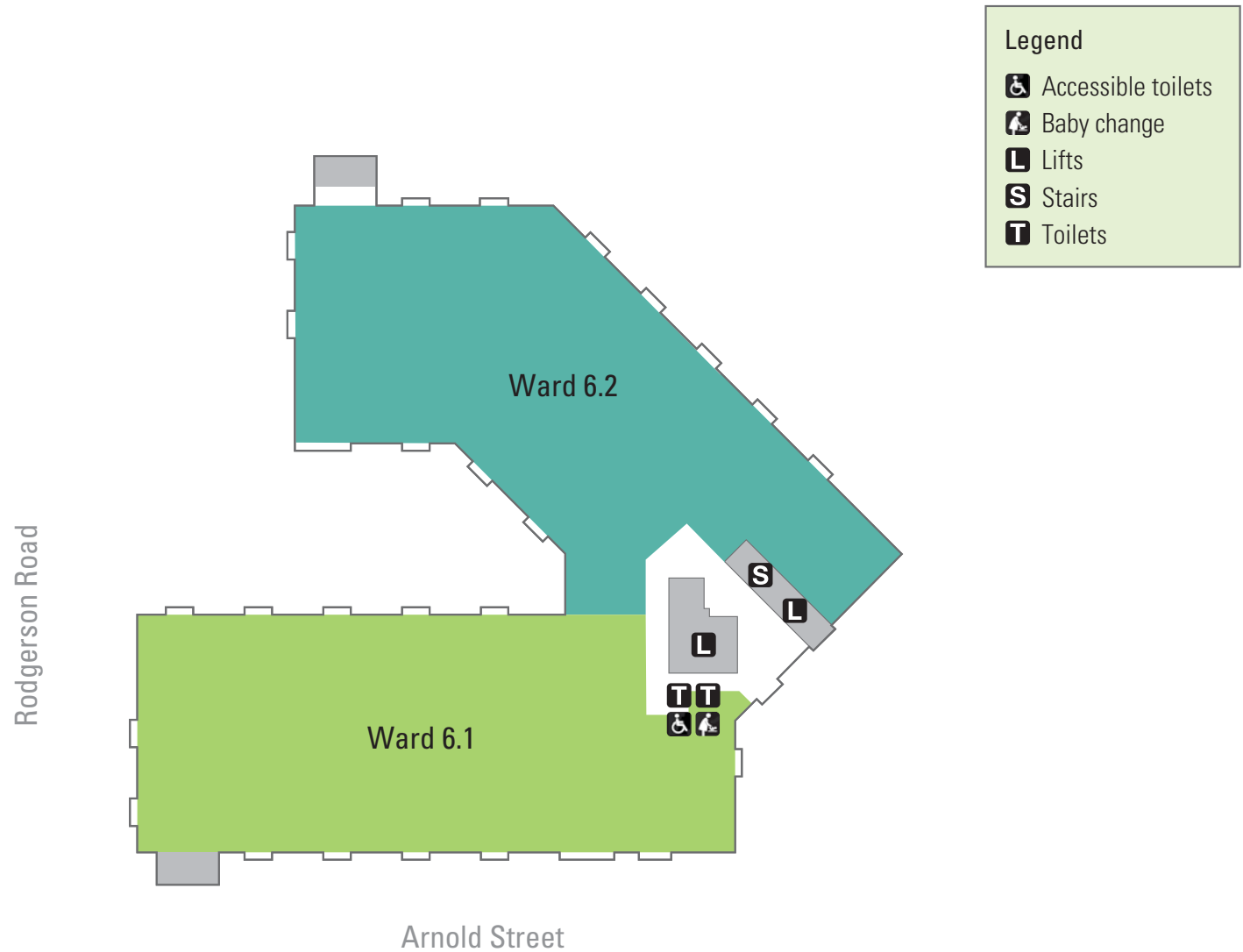

BOX HILL HOSPITAL BUILDING A

8 Arnold Street, Box Hill

EASTERN HEALTH: 1300 342 255

LEVEL 7

Ward 7.1

ENT
Gynaecology surgery
Plastic surgery
Orthopaedic surgery
Rheumatology
Urology

Ward 7.2

Gen surgery A – Bariatric
Gen surgery B – Upper GI
Gen surgery C – Colorectal
Gen surgery D – Breast
Endocrine
Thoracic surgery

Rodgerson Road

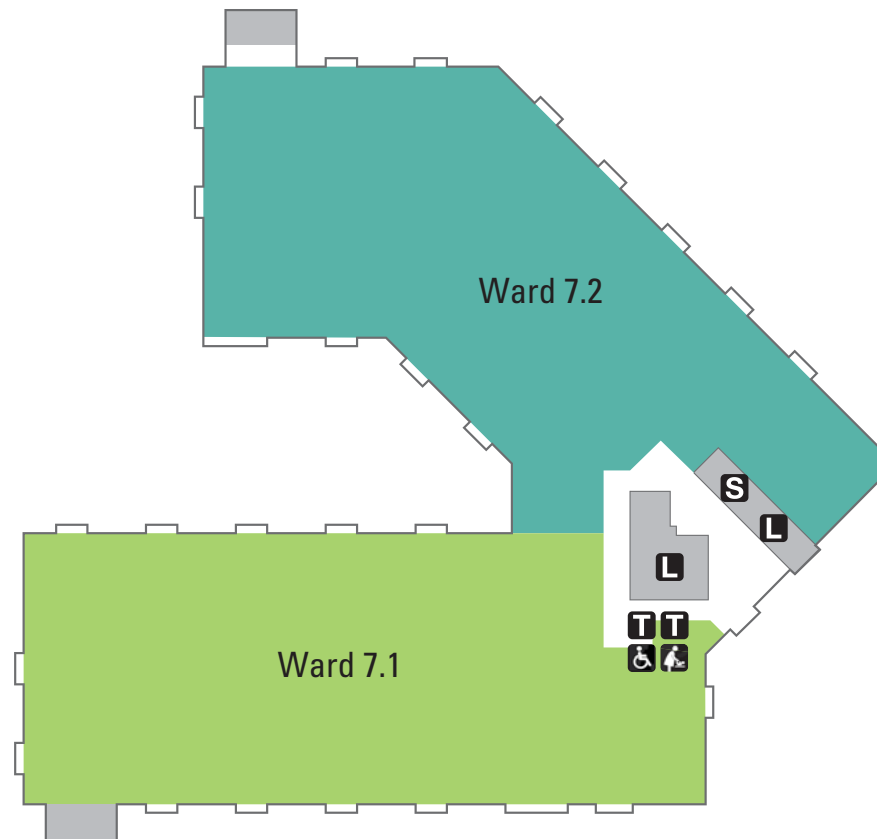

Arnold Street

BOX HILL HOSPITAL BUILDING A

8 Arnold Street, Box Hill

EASTERN HEALTH: 1300 342 255

LEVEL 8

Ward 8.1

Renal medicine
Acute dialysis chairs
Endocrinology
Vascular surgery

Ward 8.2

Future growth

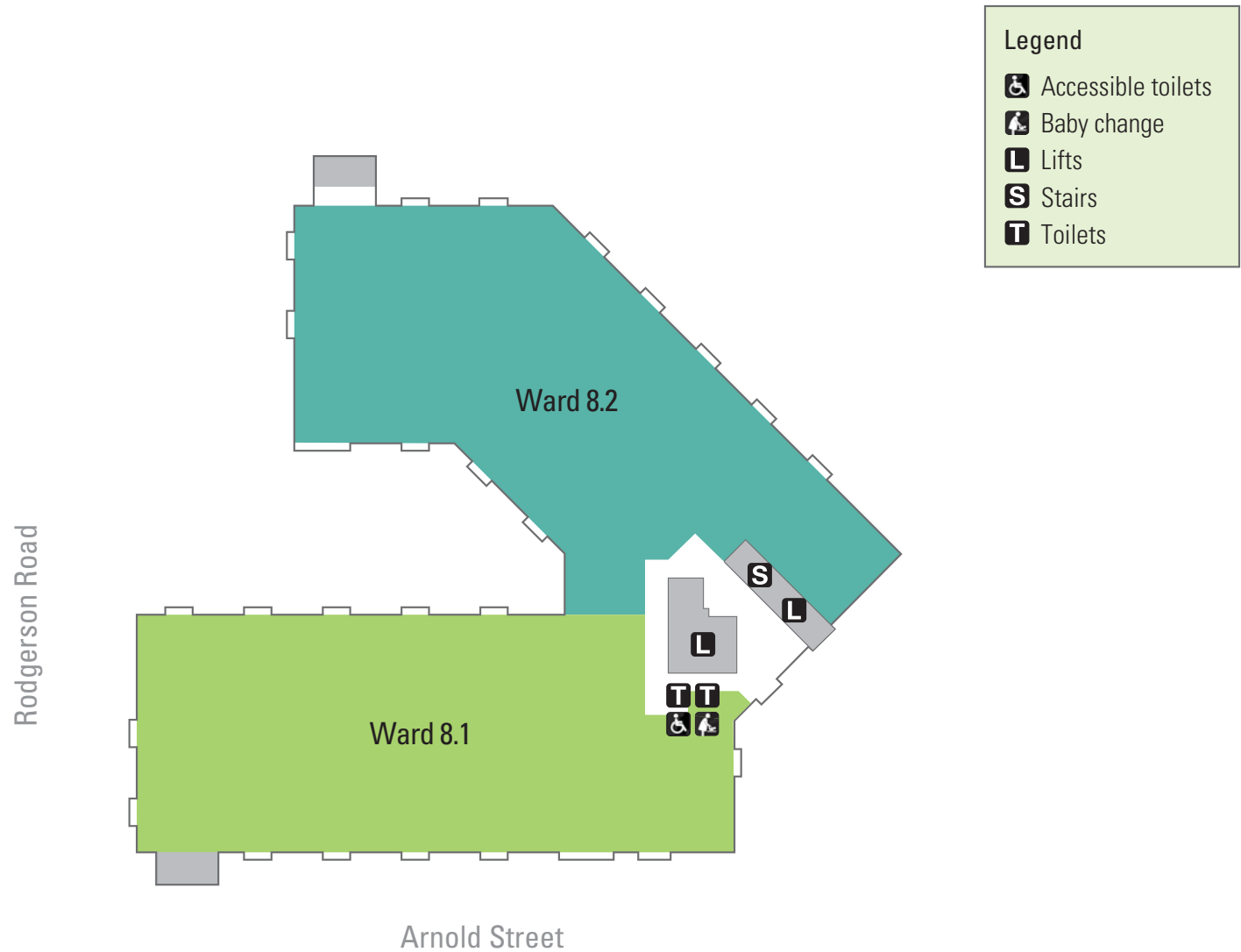

BOX HILL HOSPITAL BUILDING A

8 Arnold Street, Box Hill

EASTERN HEALTH: 1300 342 255

LEVEL 9

Ward 9.1

Future growth

Ward 9.2

Neurology

Gastroenterology

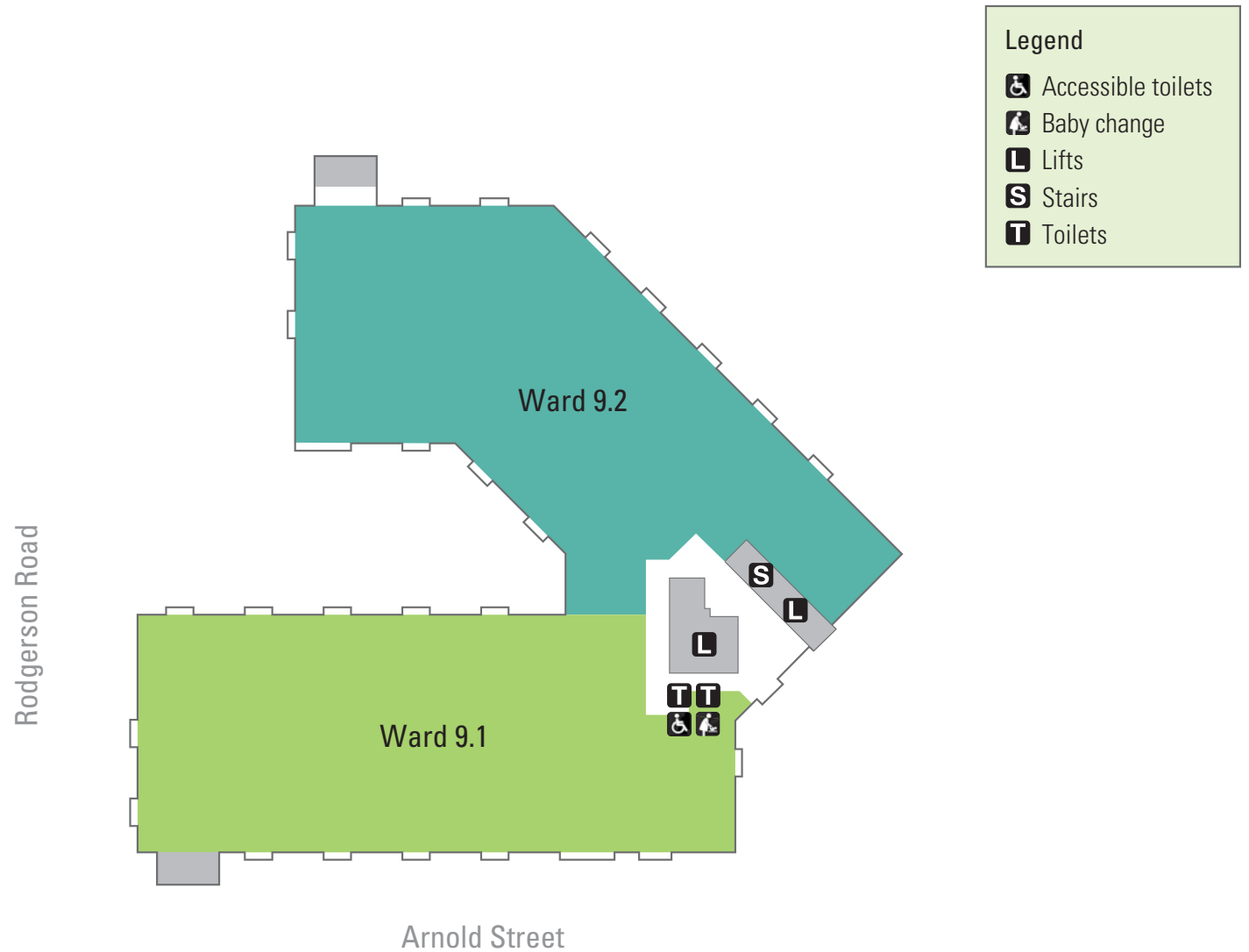

BOX HILL HOSPITAL BUILDING A

8 Arnold Street, Box Hill

EASTERN HEALTH: 1300 342 255

LEVEL B1 AND B2

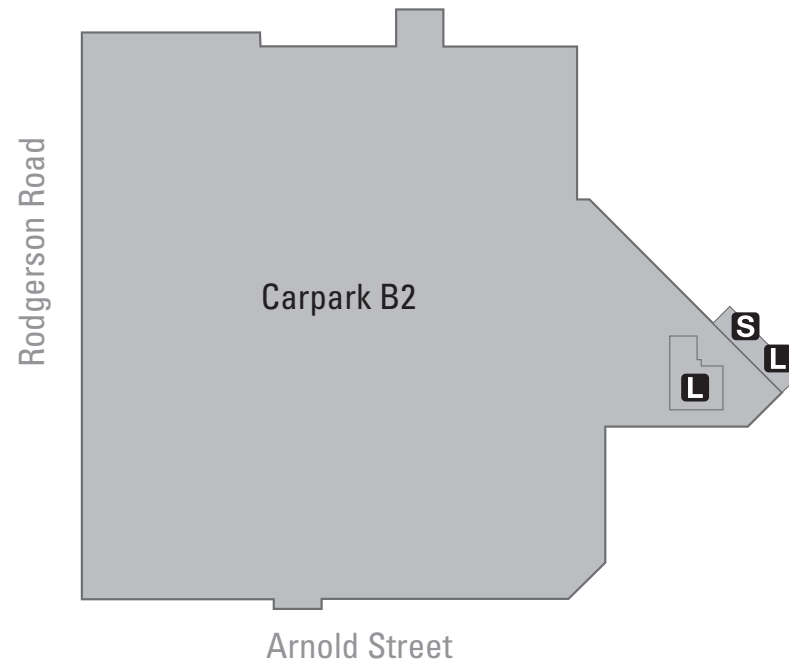
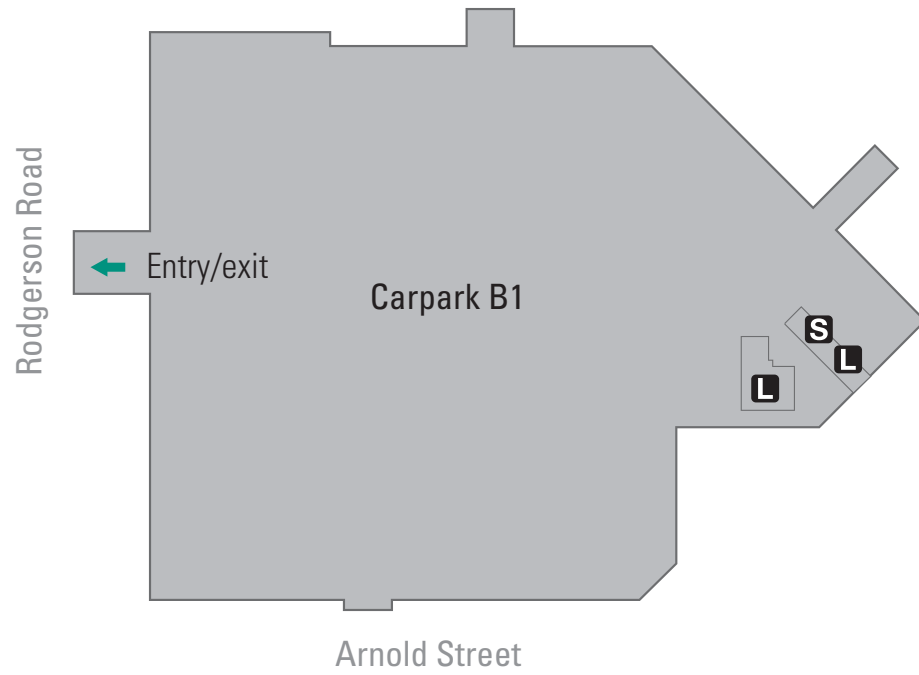

Legend

- Accessible toilets
- Baby change
- Lifts
- Stairs
- Toilets